

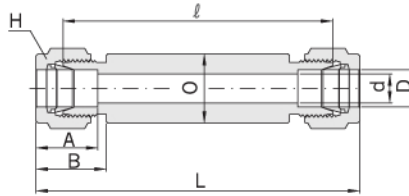

Weld Union **AWU**



Connects Fractional Tubes

Part No.	Tube O.D D		d min	H Width across flat		A	B	l	L	O
	in	mm		in	mm					
AWU - 01	1/16	1.58	1.27	5/16	7.93	8.63	10.92	64.2	71.84	10.00
AWU - 02	1/8	3.17	2.28	7/16	11.11	12.70	15.24	67.2	80.48	12.00
AWU - 03	3/16	4.76	3.04	1/2	12.70	13.71	16.00	69.0	82.00	12.00
AWU - 04	1/4	6.35	4.82	9/16	14.28	15.24	17.78	70.8	85.96	14.00
AWU - 05	5/16	7.93	6.35	5/8	15.87	16.25	18.54	73.7	87.08	16.00
AWU - 06	3/8	9.52	7.11	11/16	17.46	16.76	19.30	73.7	88.60	19.00
AWU - 08	1/2	12.70	10.41	7/8	22.22	22.86	21.84	73.7	93.68	23.00
AWU - 10	5/8	15.87	12.70	1	25.40	24.38	21.84	73.7	93.68	25.00
AWU - 12	3/4	19.05	15.74	1-1/8	28.57	24.38	21.84	73.7	93.68	28.00
AWU - 14	7/8	22.22	18.28	1-1/4	31.75	25.90	21.84	73.7	93.68	32.00
AWU - 16	1	25.40	22.35	1-1/2	38.10	31.24	26.41	78.5	102.82	35.00
AWU - 20	1 1/4	31.75	27.68	1-7/8	47.62	41.14	38.86	83.9	127.72	50.00
AWU - 24	1 1/2	38.10	34.03	2-1/4	57.15	50.03	45.21	86.1	140.42	55.00
AWU - 32	2	50.80	45.97	3	76.20	67.56	62.73	100.9	175.46	80.00

Connects Metric Tubes

Part No.	Tube O.D D	d min	H Width across flat	A	B	l	L	O
AWU - M02	2	1.7	12	12.9	15.3	67.3	80.3	12.0
AWU - M03	3	2.4	12	12.9	15.3	67.3	80.3	12.0
AWU - M04	4	2.4	12	13.7	16.1	69.0	82.2	12.0
AWU - M06	6	4.8	14	15.3	17.7	70.5	85.5	12.0
AWU - M08	8	6.3	16	16.2	18.6	72.1	87.2	16.0
AWU - M10	10	7.9	19	17.2	19.5	73.7	89.0	19.0
AWU - M12	12	9.5	22	22.8	22.0	73.6	93.9	23.0
AWU - M15	15	11.9	25	24.4	22.0	73.7	94.0	25.0
AWU - M16	16	12.7	25	24.4	22.0	73.7	94.0	28.0
AWU - M18	18	15.1	30	24.4	22.0	73.7	94.0	28.0
AWU - M20	20	15.9	32	26.0	22.0	73.7	94.0	32.0
AWU - M22	22	18.3	32	26.0	22.0	73.7	94.0	32.0
AWU - M25	25	21.8	38	31.3	26.5	78.6	102.5	38.0
AWU - M28	28	21.8	46	36.6	36.6	81.7	122.2	45.0
AWU - M32	32	28.6	50	42.0	41.6	87.1	133.2	50.0
AWU - M38	38	33.7	60	49.4	47.9	90.9	145.8	60.0

* Specified length to be shown as last designator in part number
Example : CBUW-8L100

Thermocouple Weld Union **AWUT**

Bore Through weld union handle thermocouple or dip tubes with ease. For correct part number, just add "T" as s suffix to CBUW, the weld union designator.

Example : CBUWT-8-S316 1/2" tube stainless steel 316