

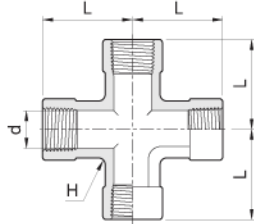

Cross P-FC



Female NPT all ports.

Part No.	Pipe Size	L	d	H Width Across Flat	Pressure Rating			
					SS316 Carbon Steel		Brass	
					psig	bar	psig	bar
P - FC - 02N	1/8	24.0	8.9	12.7	6,500	447	3,200	220
P - FC - 04N	1/4	29.0	11.7	17.5	6,600	454	3,300	227
P - FC - 06N	3/8	34.5	15.0	20.6	5,300	365	2,600	179
P - FC - 08N	1/2	37.0	18.7	25.4	4,900	337	2,400	165
P - FC - 12N	3/4	46.5	23.5	31.8	4,600	316	2,300	158
P - FC - 16N	1	48.8	29.7	42.9	4,400	303	2,200	151

Hex Coupling P-HC

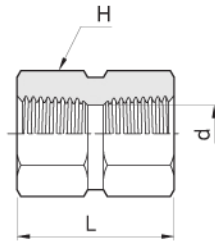

Female NPT Both Ends.

Part No.	Pipe Size	L	d	H Width Across Flat	Pressure Rating			
					SS316 Carbon Steel		Brass	
					psig	bar	psig	bar
P - HC - 02N	1/8	20.3	8.9	14.20	6,500	447	3,200	220
P - HC - 04N	1/4	30.0	11.7	19.05	6,600	454	3,300	227
P - HC - 06N	3/8	33.0	15.0	22.20	5,300	365	2,600	179
P - HC - 08N	1/2	39.4	18.7	26.90	4,900	337	2,400	165
P - HC - 12N	3/4	41.0	23.5	31.80	4,600	316	2,300	158
P - HC - 16N	1	50.5	29.7	41.20	4,400	303	2,200	151

Hex Reducing Coupling P-HRC

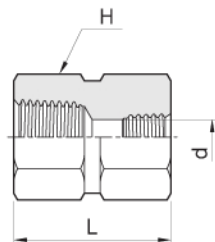

Female NPT to Reduced Female NPT.

Part No.	Pipe Size	Reduced Pipe Size	L	d	H Width Across Flat	Pressure Rating			
						SS316 Carbon Steel		Brass	
						psig	bar	psig	bar
P - HRC - 0402N	1/4	1/8	31.2	8.9	19.05	6,500	447	3,200	220
P - HRC - 0604N	3/8	1/4	34.8	11.7	22.20	5,300	365	2,600	179
P - HRC - 0802N	1/2	1/8	39.4	8.9	26.90	4,900	337	2,400	165
P - HRC - 0804N	1/2	1/4	44.2	11.7	26.90	4,900	337	2,400	165
P - HRC - 0806N	1/2	3/8	45.0	15.0	26.90	4,900	337	2,400	165
P - HRC - 1204N	3/4	1/4	45.7	11.7	31.80	4,600	316	2,300	158
P - HRC - 1208N	3/4	1/2	52.0	18.7	31.80	4,600	316	2,300	158
P - HRC - 1604N	1	1/4	50.8	11.7	41.20	4,600	316	2,300	158
P - HRC - 1608N	1	1/2	55.4	18.7	41.20	4,400	303	2,200	151
P - HRC - 1612N	1	3/4	57.0	23.5	41.20	4,400	303	2,200	151