

O-Seal Straight Thread Male Adapter

**AMAO**

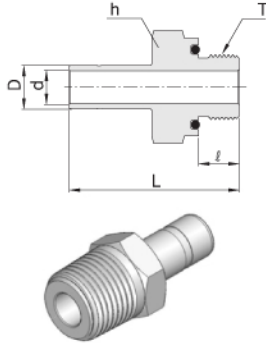

**Connects Fractional Hn-Lok Port To ISO Female Straight Thread**

Part No.	Tube O.D. D		Straight Thread T(U)	d min.	Width across flat h		ℓ	L	O-ring Uniform Size Number
	in	mm			in	mm			
AMAO -02T02U	1/8	3.17	5/16-24	2.03	9/16	14.28	8.63	32.51	-011
AMAO -03T03U	1/8	3.17	3/8-24	3.05	5/8	15.87	9.65	35.05	-013
AMAO -04T04U	1/4	6.35	7/16-20	4.32	3/4	19.05	10.41	39.11	-013
AMAO -05T05U	5/16	7.93	1/2-20	5.59	7/8	22.22	11.18	41.65	-112
AMAO -06T06U	3/8	9.52	9/16-18	6.86	15/16	23.81	11.94	43.18	-113
AMAO -08T08U	1/2	12.70	3/4-16	9.40	1 1/8	28.57	11.94	49.53	-116

AN Tube Adapter

**AATA**

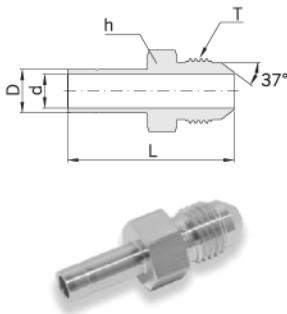

**Connects Fractional Hn-Lok Port To AN Flared Tube**

Part No.	Tube O.D. D		AN Tube O.D. D		Straight Thread T(U)	d min.	Width across flat h		L
	in	mm	in	mm			in	mm	
AATA -04T04	1/4	6.35	1/4	6.35	7/16-20	4.32	1/2	12.70	37.08
AATA -06T04	3/8	9.52	1/4	6.35	7/16-20	4.32	1/2	12.70	38.86
AATA -06T06	3/8	9.52	3/8	9.52	9/16-18	6.86	5/8	15.87	39.62
AATA -08T08	1/2	12.70	1/2	12.70	3/4-16	9.40	13/16	20.63	48.51
AATA -12T12	3/4	19.05	3/4	19.05	1 1/16-12	14.73	1 1/8	28.58	56.13
AATA -16T16	1	25.40	1	25.40	1 5/16-12	20.32	1 3/8	34.92	65.53

Weld Adapter

**AWA**

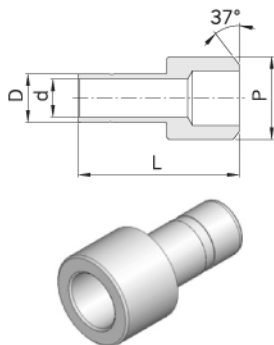

**Connects Fractional Hn-Lok Port To Pipe**

Part No.	Tube O.D. D		Male Pipe Size P		d min.	L
	in	mm	Nom.	mm		
AWA -04T04P	1/4	6.35	1/4	13.70	4.32	28.96
AWA -06T08P	3/8	9.52	1/2	21.30	6.86	37.08
AWA -08T08P	1/2	12.70	1/2	21.30	9.40	42.16
AWA -08T12P	1/2	12.70	3/4	26.67	9.40	42.67
AWA -12T12P	3/4	19.05	3/4	26.67	14.73	47.50