

Ferrule Set

AFS



Nut Ferrule Set

ANFS

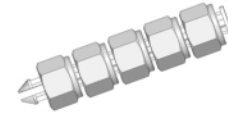

Fractional

Metric

| Part No. | Tube O.D. | | Part No. | Tube O.D. |
|----------|-----------|-------|-----------|-----------|
| | in | mm | | |
| AFS - 01 | 1/16 | 1.58 | AFS - M02 | 2 |
| AFS - 02 | 1/8 | 3.17 | AFS - M03 | 3 |
| AFS - 03 | 3/16 | 4.76 | AFS - M04 | 4 |
| AFS - 04 | 1/4 | 6.35 | AFS - M06 | 6 |
| AFS - 05 | 5/16 | 7.93 | AFS - M08 | 8 |
| AFS - 06 | 3/8 | 9.52 | AFS - M10 | 10 |
| AFS - 08 | 1/2 | 12.70 | AFS - M12 | 12 |
| AFS - 10 | 5/8 | 15.87 | AFS - M15 | 15 |
| AFS - 12 | 3/4 | 19.05 | AFS - M16 | 16 |
| AFS - 14 | 7/8 | 22.22 | AFS - M18 | 18 |
| AFS - 16 | 1 | 25.40 | AFS - M20 | 20 |
| | | | AFS - M22 | 22 |
| | | | AFS - M25 | 25 |

■ Hn-Lok ferrule set is composed of one back ferrule and one front ferrule.

Fractional

Metric

| Part No. | Tube O.D. | | Part No. | Tube O.D. |
|-----------|-----------|-------|------------|-----------|
| | in | mm | | |
| ANFS - 01 | 1/16 | 1.58 | ANFS - M02 | 2 |
| ANFS - 02 | 1/8 | 3.17 | ANFS - M03 | 3 |
| ANFS - 03 | 3/16 | 4.76 | ANFS - M04 | 4 |
| ANFS - 04 | 1/4 | 6.35 | ANFS - M06 | 6 |
| ANFS - 05 | 5/16 | 7.93 | ANFS - M08 | 8 |
| ANFS - 06 | 3/8 | 9.52 | ANFS - M10 | 10 |
| ANFS - 08 | 1/2 | 12.70 | ANFS - M12 | 12 |
| ANFS - 10 | 5/8 | 15.87 | ANFS - M15 | 15 |
| ANFS - 12 | 3/4 | 19.05 | ANFS - M16 | 16 |
| ANFS - 14 | 7/8 | 22.22 | ANFS - M18 | 18 |
| ANFS - 16 | 1 | 25.40 | ANFS - M20 | 20 |
| | | | ANFS - M22 | 22 |
| | | | ANFS - M25 | 25 |

■ Hn-Lok ferrule set is composed of one nut, one back ferrule and one front ferrule.

Tube Insert for Nylon or Soft Plastic Tubing

AI

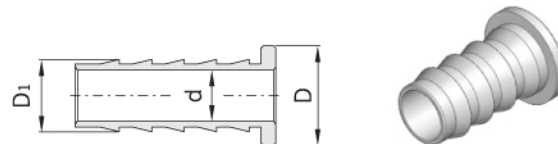

Fractional

| Part No. | Tube O.D. | | Tube I.D. | | Bore I.D. | |
|-------------|-----------|-------|----------------|-------|-----------|-------|
| | D | | D ₁ | | d | |
| | in | mm | in | mm | in | mm |
| AI - 0302 | 3/16 | 4.76 | 1/8 | 3.17 | 0.09 | 1.70 |
| AI - 0402 | 1/4 | 6.35 | 1/8 | 3.17 | 0.09 | 1.70 |
| AI - 04M4.3 | 1/4 | 6.35 | 0.17 | 4.32 | 0.11 | 3.10 |
| AI - 0403 | 1/4 | 6.35 | 3/16 | 4.76 | 0.14 | 3.56 |
| AI - 0502 | 5/16 | 7.93 | 1/8 | 3.17 | 0.09 | 2.29 |
| AI - 0503 | 5/16 | 7.93 | 3/16 | 4.76 | 0.12 | 3.50 |
| AI - 0504 | 5/16 | 7.93 | 1/4 | 6.35 | 0.19 | 4.83 |
| AI - 0603 | 3/8 | 9.52 | 3/16 | 4.76 | 0.12 | 3.05 |
| AI - 0604 | 3/8 | 9.52 | 1/4 | 6.35 | 0.19 | 4.83 |
| AI - 0804 | 1/2 | 12.70 | 1/4 | 6.35 | 0.19 | 4.83 |
| AI - 0806 | 1/2 | 12.70 | 3/8 | 9.52 | 0.31 | 7.87 |
| AI - 1006 | 5/8 | 15.87 | 3/8 | 9.52 | 0.31 | 7.87 |
| AI - 1008 | 5/8 | 15.87 | 1/2 | 12.70 | 0.44 | 11.00 |
| AI - 1208 | 3/4 | 19.05 | 1/2 | 12.70 | 0.44 | 11.00 |
| AI - 1210 | 3/4 | 19.05 | 5/8 | 15.87 | 0.56 | 14.22 |
| AI - 1612 | 1 | 25.40 | 3/4 | 19.05 | 0.69 | 17.53 |

Metric

| Part No. | Tube O.D. | Tube I.D. | Bore I.D. |
|-------------|-----------|----------------|-----------|
| | D | D ₁ | d |
| AI - M06M04 | 6 | 4 | 2.4 |
| AI - M08M06 | 8 | 6 | 4.8 |
| AI - M10M08 | 10 | 8 | 6.4 |
| AI - M12M08 | 12 | 8 | 6.4 |
| AI - M12M10 | 12 | 10 | 8.3 |

Hn-Lok Tube Inserts are used to secure the nylon or other soft plastic tubing to Hn-Lok tube fittings.

To choose the proper Hn-Lok Tube insert, check if O.D. and I.D.

of the tubing are the same as dimension D and D₁ of tube inserts, respectively