

Union Ball Joint
P-UBJ

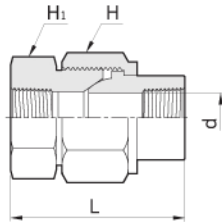

Female NPT Both Ends.

Part No.	Pipe Size	L	d	H Width Across Flat	H ₁ Width Across Flat	Pressure Rating			
						SS316 Carbon Steel		Brass	
						psig	bar	psig	bar
P - UBJ - 02N	1/8	45.7	6.9	28.6	23.8	6,500	447	3,200	220
P - UBJ - 04N	1/4	59.4	9.1	34.9	30.2	6,600	454	3,300	227
P - UBJ - 06N	3/8	63.5	13.2	38.1	33.3	5,300	365	2,600	179
P - UBJ - 08N	1/2	68.6	15.7	44.5	41.3	4,900	337	2,400	165
P - UBJ - 12N	3/4	79.2	22.4	50.8	47.6	4,600	316	2,300	158
P - UBJ - 16N	1	90.4	26.2	63.5	60.3	4,400	303	2,200	151

Instrument Weld Fittings

Union
P-WU

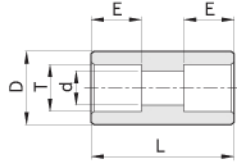

Part No.	T Tube O.D.	L	D	d	E	Working Pressure SS316	
						psig	bar
P - WU - 4T	1/4	19.1	13.0	4.6	7.1	10,000	689
P - WU - 6T	3/8	22.4	15.8	7.1	7.9	7,600	523
P - WU - 8T	1/2	26.9	19.0	10.2	9.7	6,200	427
P - WU - 10T	5/8	30.2	24.0	12.7	10.4	6,400	440
P - WU - 12T	3/4	33.3	26.9	15.7	11.2	5,500	378
P - WU - 16T	1	36.6	35.0	22.1	15.7	5,200	358

Pipe Weld to Tube Socket Weld
P-WPT

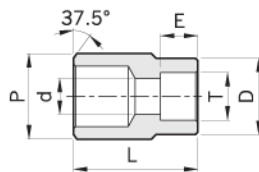

Part No.	P Pipe Size	T Tube Socket Size	L	D	d	E	Working Pressure SS316	
							psig	bar
P - WPT - 4P4T	1/4	1/4	22.4	13.7	4.6	7.1	9,600	661
P - WPT - 6P6T	3/8	3/8	26.2	15.3	7.1	7.9	7,600	523
P - WPT - 6P8T	3/8	1/2	27.9	18.5	10.2	9.7	6,200	427
P - WPT - 8P4T	1/2	1/4	28.4	12.2	4.6	7.1	7,300	502
P - WPT - 8P6T	1/2	3/8	28.4	15.3	7.1	7.9	7,300	502
P - WPT - 8P8T	1/2	1/2	30.2	18.5	10.2	9.7	6,200	427
P - WPT - 12P6T	3/4	3/8	38.1	15.3	7.1	7.9	6,200	427
P - WPT - 12P8T	3/4	1/2	38.1	18.5	10.2	9.7	6,200	427

Used to reduce from a pipe butt weld or pipe socket weld to a smaller tube size